

CAR PARKING LAYOUT UNITS 2 & 3 KNOWSLEY VILLAGE HALL SCHOOL LANE

1:100 SCALE

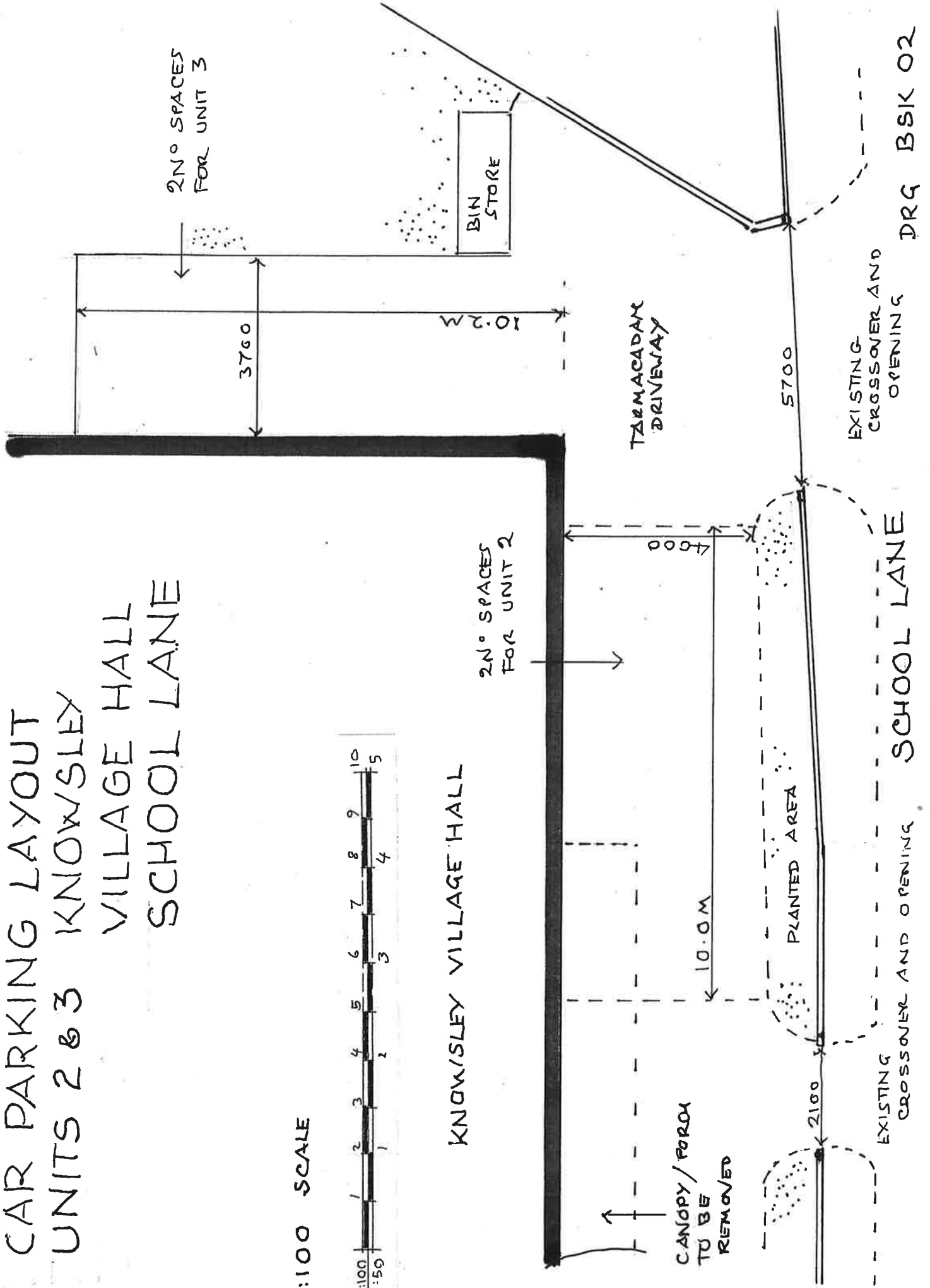

CAR PARKING LAYOUT UNITS 2 & 3 KNOWSLEY VILLAGE HALL SCHOOL LANE

1:100 SCALE



KNOWSLEY VILLAGE HALL

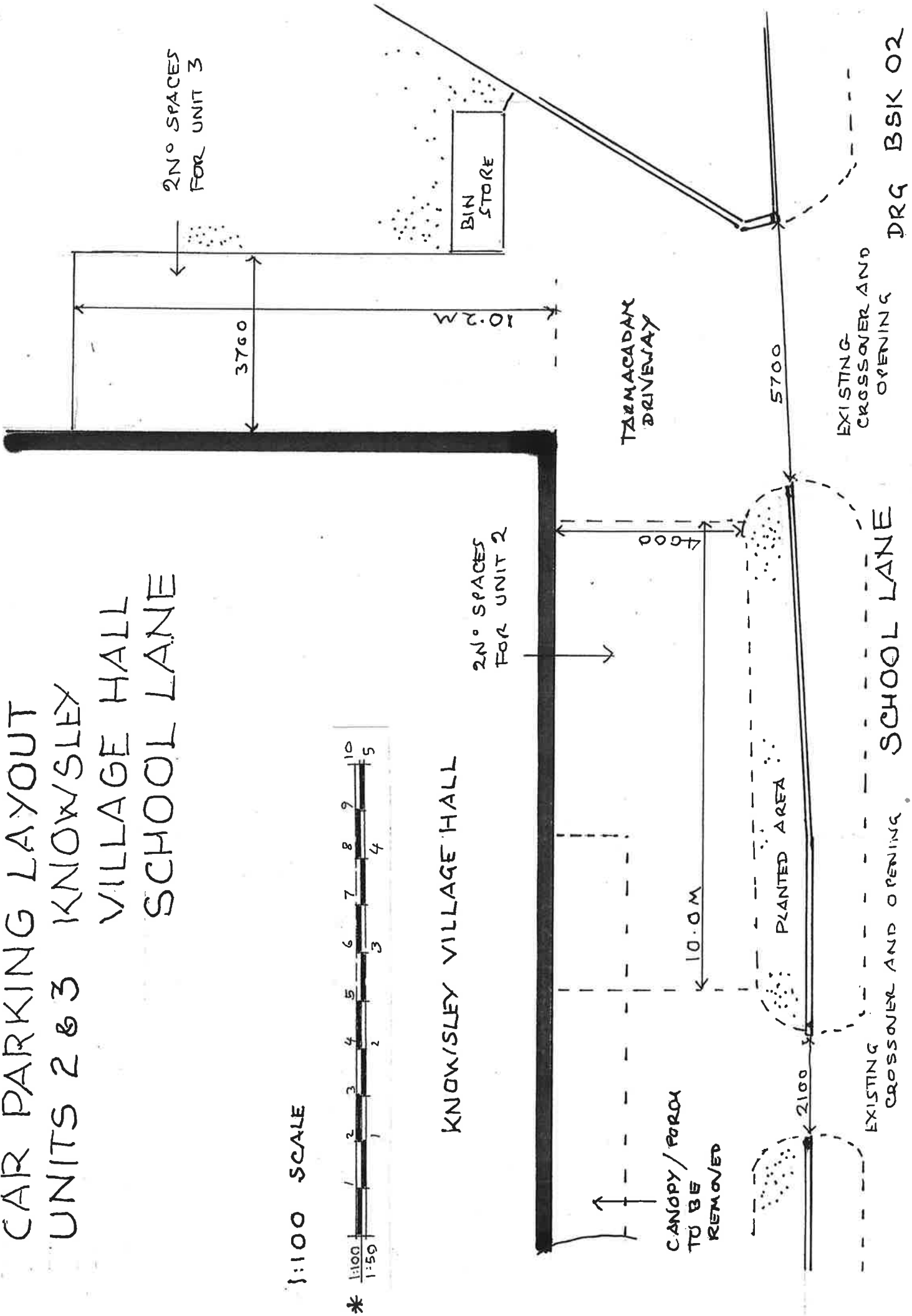

DRG BSK 02

CAR PARKING LAYOUT UNIT 1 @ KNOWSLEY VILLAGE HALL SCHOOL LANE

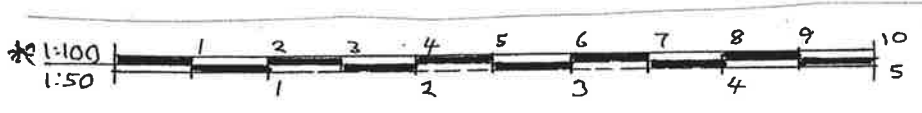
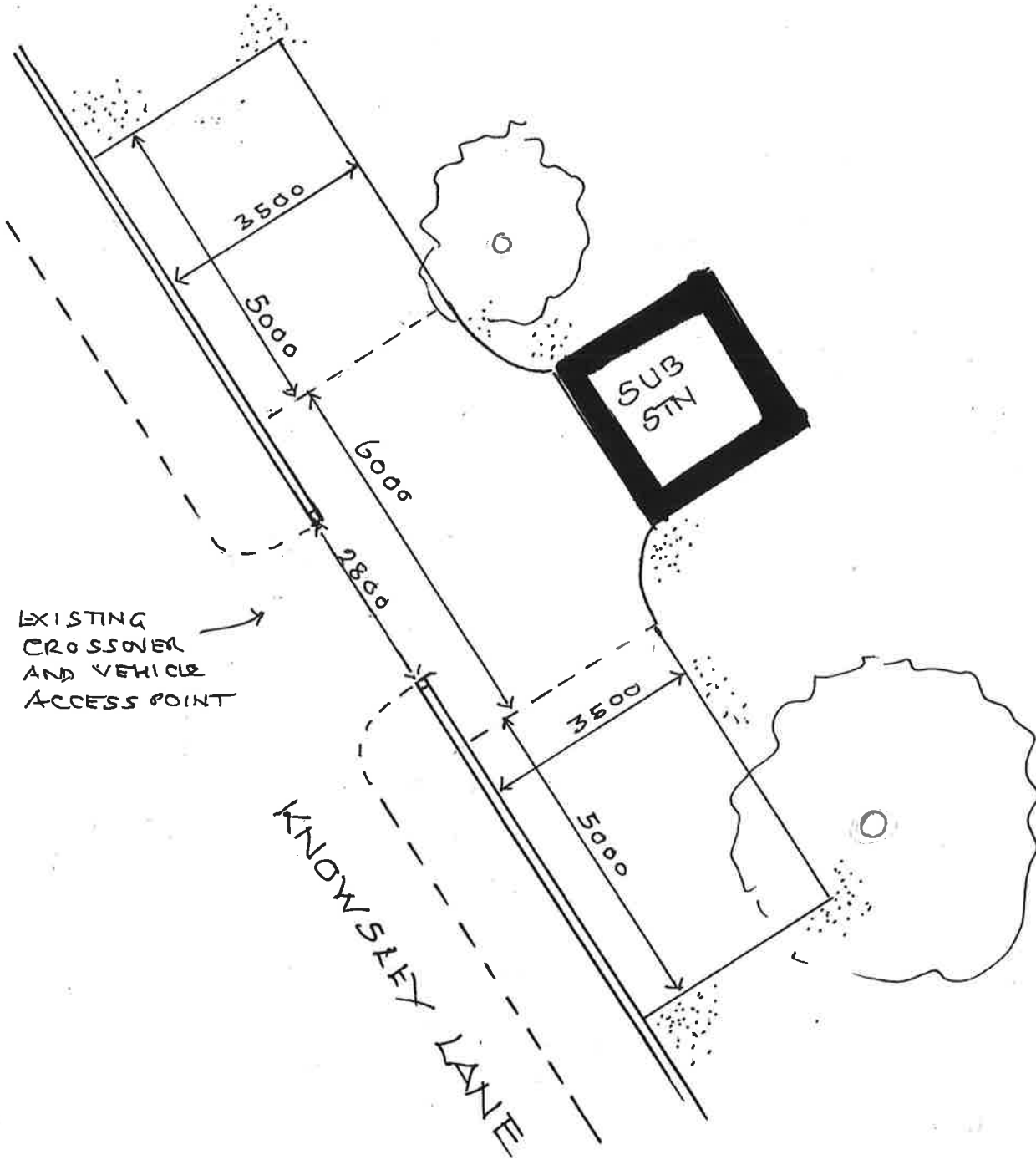

1:100 SCALE

DRG BSK 01

CAR PARKING LAYOUT UNIT 1 @ KNOWSLEY VILLAGE HALL SCHOOL LANE

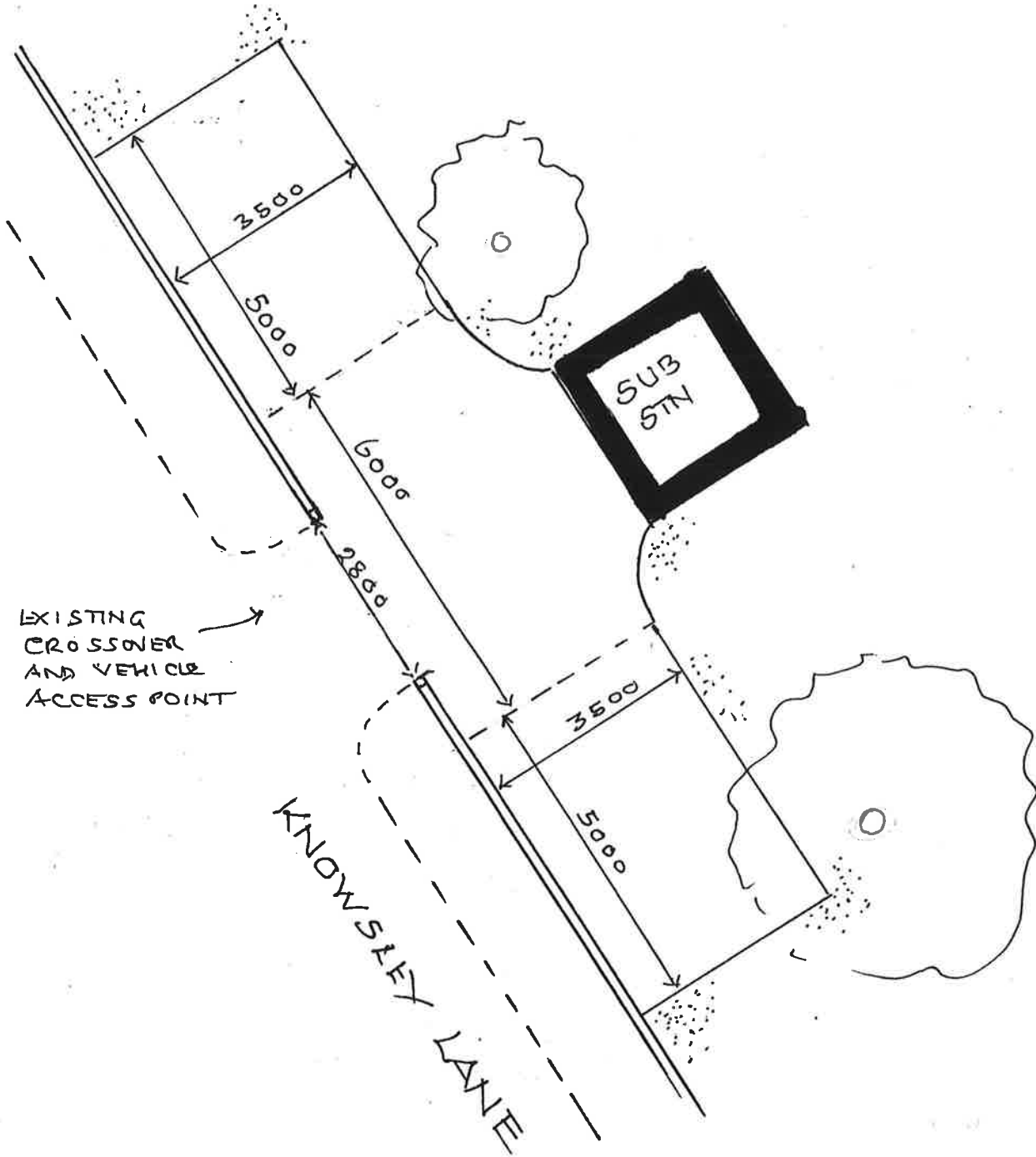

1:100 SCALE

DRG BSK 01

CAR PARKING LAYOUT UNIT 1 & 2 KNOWSLEY VILLAGE HALL SCHOOL LANE

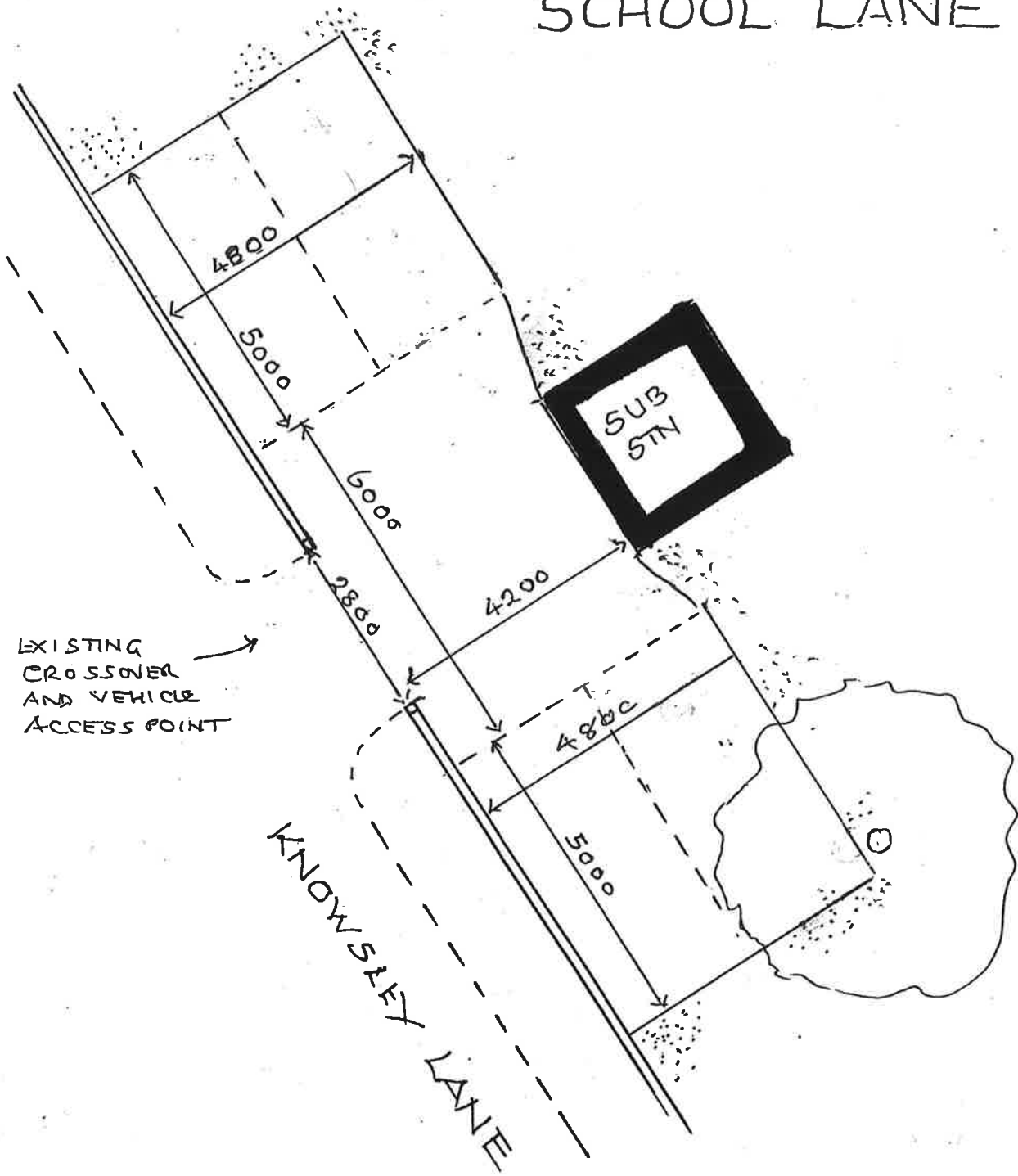

1:100 SCALE

DRG BSK 01A

CAR PARKING LAYOUT UNIT 1 & 2 KNOWSLEY VILLAGE HALL SCHOOL LANE

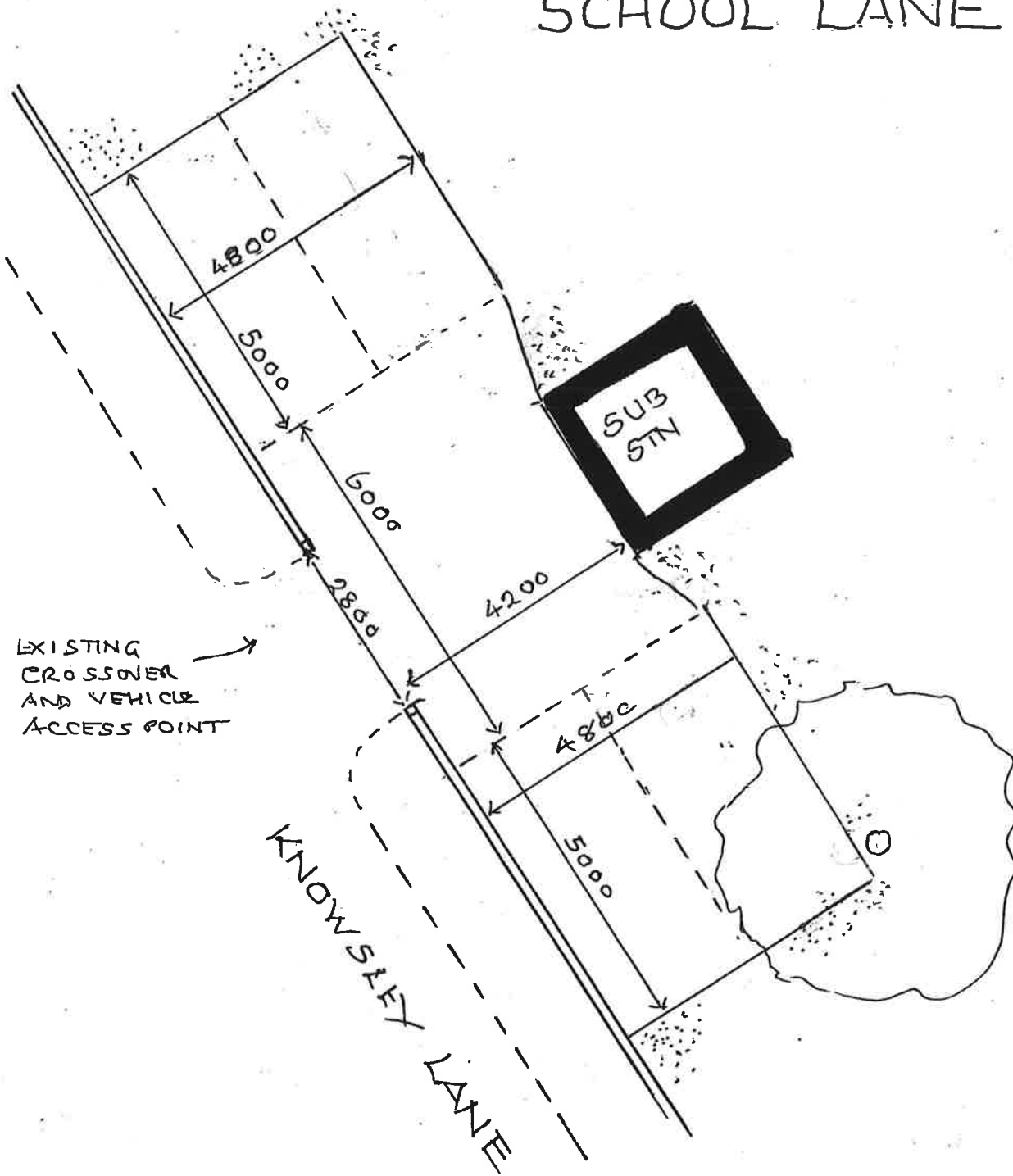

EXISTING
CROSSOVER
AND VEHICLE
ACCESS POINT

KNOWSLEY LANE

SUB
STN



1:100 SCALE

DRG BSK 01A

CAR PARKING LAYOUT UNIT 3: KNOWSLEY VILLAGE HALL SCHOOL LANE

1:100 SCALE



KNOWSLEY VILLAGE HALL

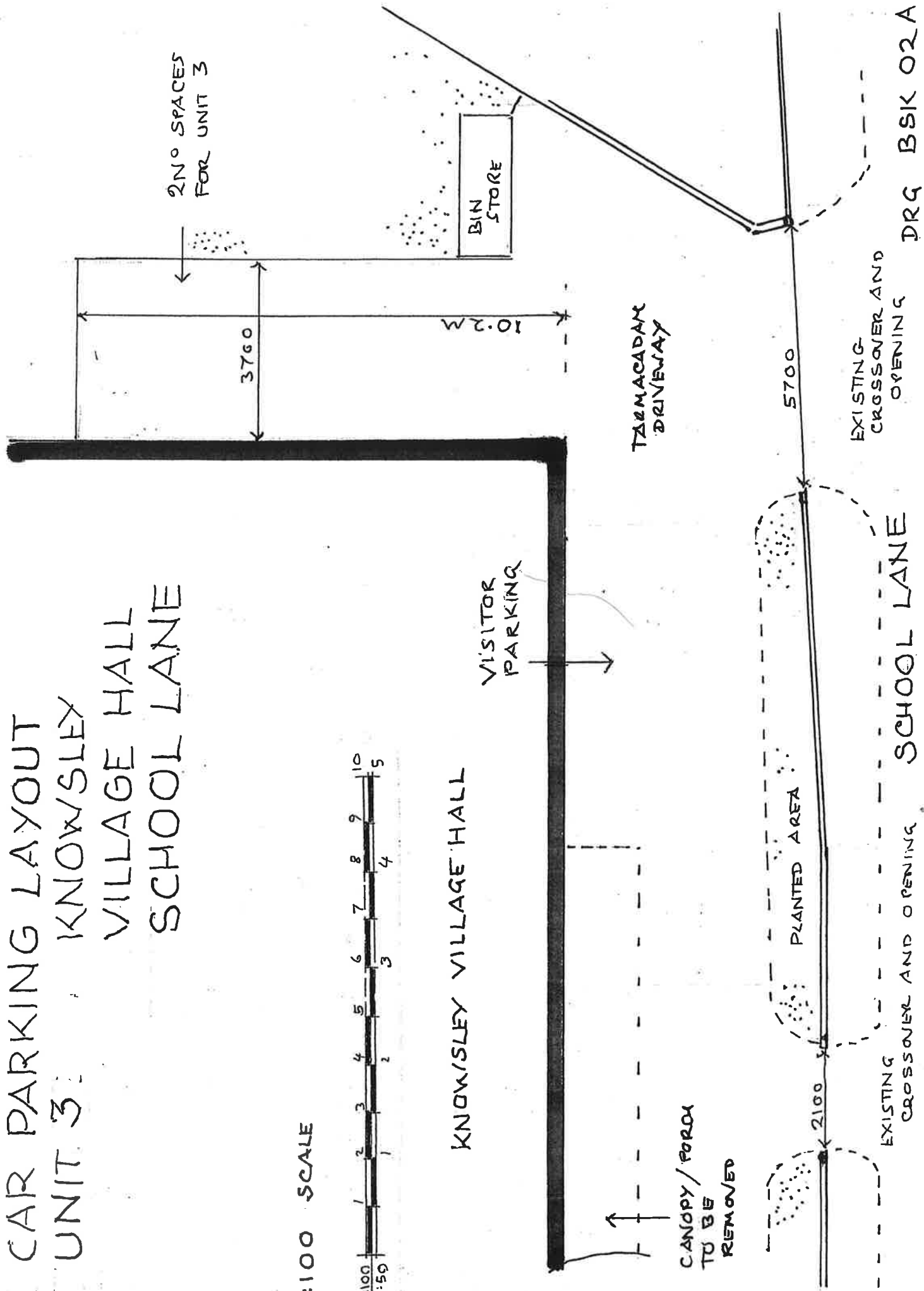

CAR PARKING LAYOUT UNIT 3: KNOWSLEY VILLAGE HALL SCHOOL LANE

1:100 SCALE



KNOWSLEY VILLAGE HALL

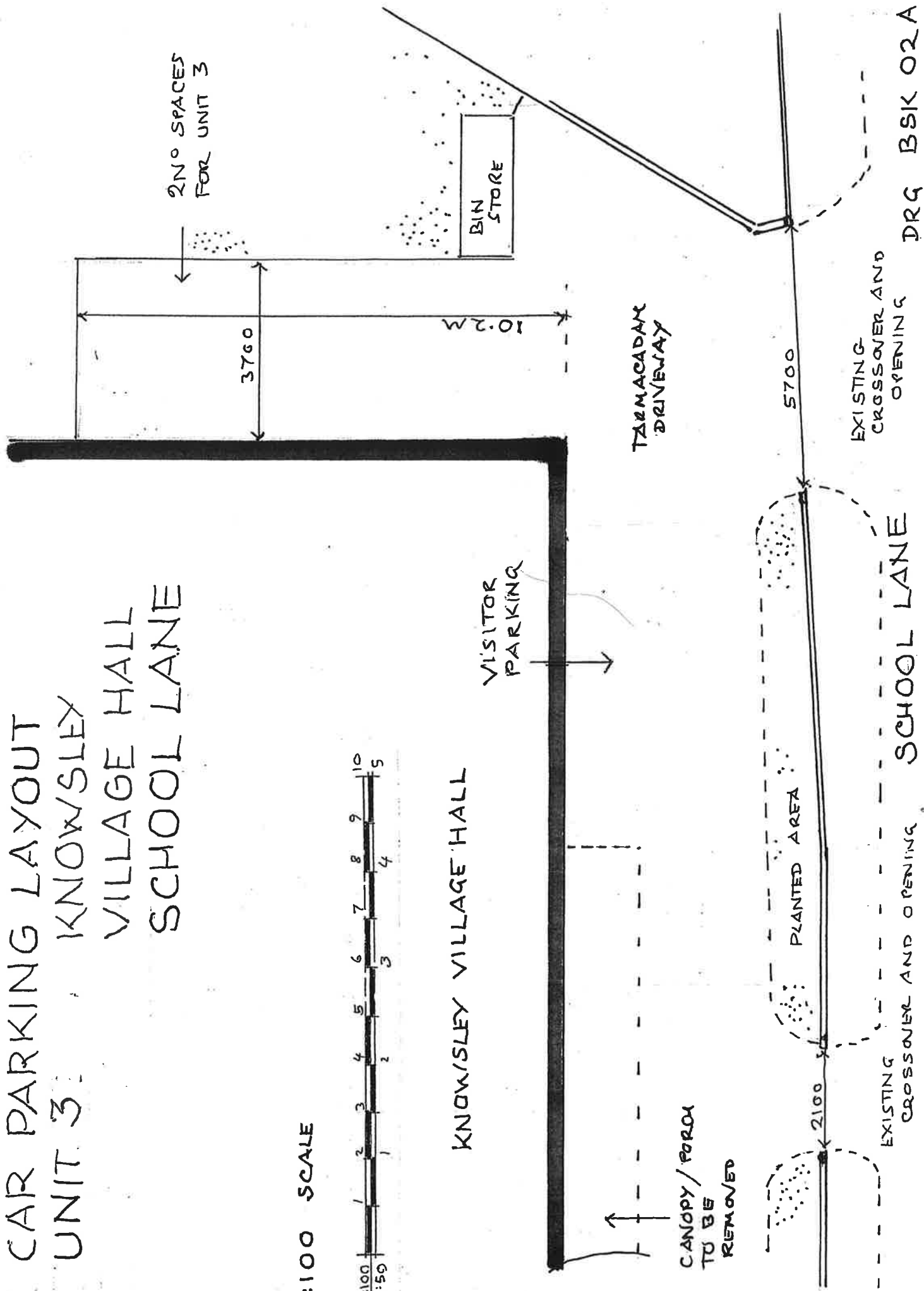

2 NO SPACES FOR UNIT 3

BIN STORE

3760

10.2M

TARMACADAM DRIVEWAY

5700

EXISTING CROSSOVER AND OPENING

SCHOOL LANE

EXISTING CROSSOVER AND OPENING

2100

CANOPY / PORCH TO BE REMOVED

PLANTED AREA

DRG BSK 02A