

SCALE 1:100

Conway Architectural Design shall have no responsibility for any use made of this document other than for that which it was prepared and issued. This drawing should not be scaled. Work to figured dimensions only. All dimensions and levels to be checked on site. No building work is to be started until all relevant approvals are in place. Any discrepancies should be reported to Conway Architectural Design. This drawing should not be reproduced without written permission from Conway Architectural Design. **Standard Building Regs Notes are to be provided by Conway Architectural Design prior to a building regs application being submitted.**

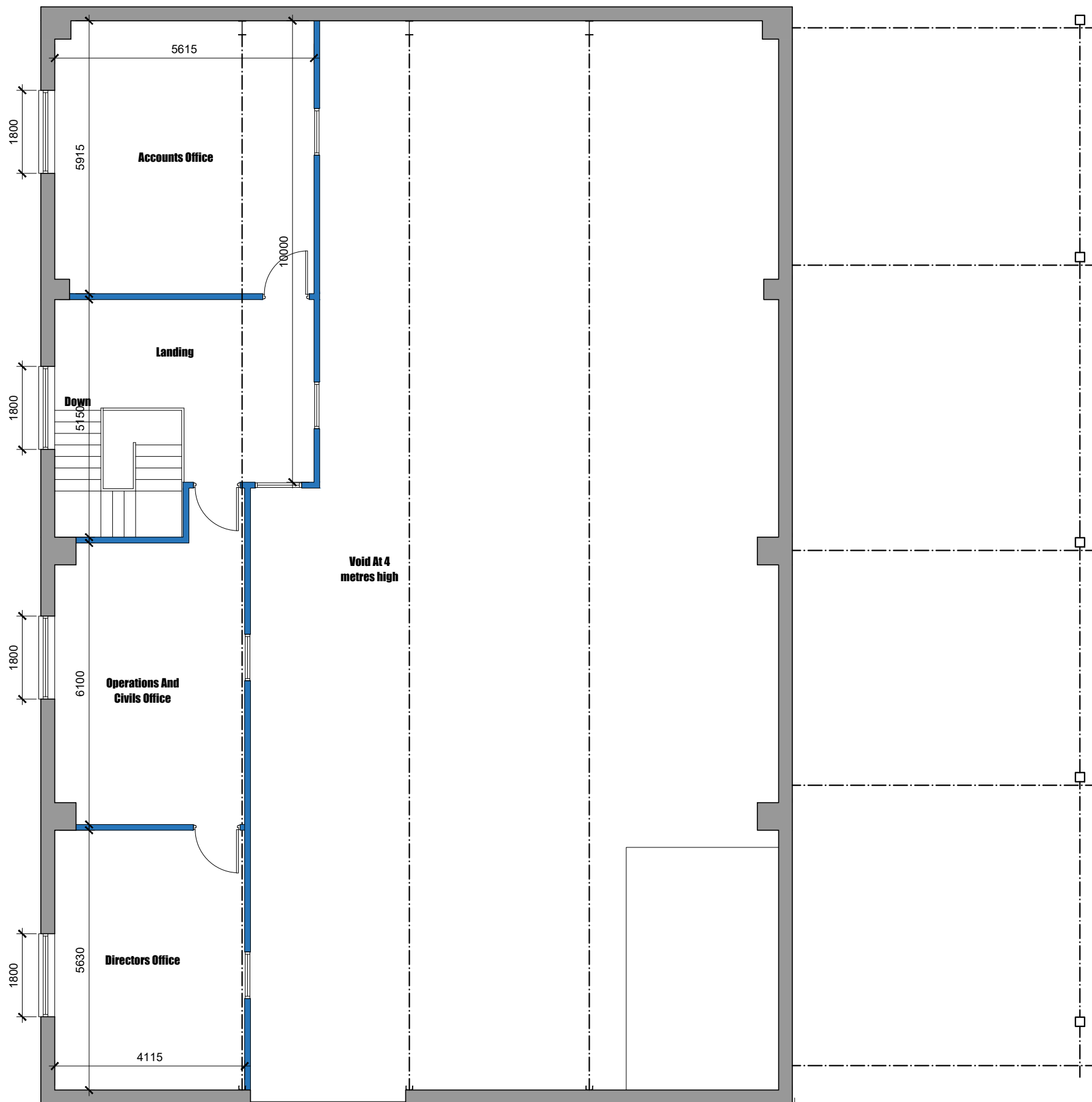

6 Conway Close
Alkrington
Middleton
Manchester, M24 1EW

E: conway-design@outlook.com

JOB TITLE : Office Extension Within Existing Warehouse
ADDRESS : 3 Webber Road, Knowsley Industrial Park
DRAWING TITLE : Proposed First Floor Plan
SCALE : 1:100 @ A3
DRAWN : xxx DATE : 20.01.26

JOB NO./
DWG NO.

987-06